

Field Installation and Usage Instructions

Part No. TMA71-15

Phenolic Arm and Hand Table

For All Model TMM Standard Chairs

5516 S.W. 1st Lane – Ocala, FL 34474-9307
Phone: 1-800-237-3377 - Fax: 1-352-854-9544
www.transmotionmedical.com

Document No.: IM TMA71-15
Revision: B

TABLE OF CONTENTS

IMPORTANT NOTES ABOUT THIS MANUAL	3
SPECIAL NOTES - SIGNAL WORDS	3
TOOLS REQUIRED.....	4
PARTS INCLUDED IN TMA71-15 KIT.....	4
INSTALLING PHENOLIC ARM AND HAND TABLE.....	4
CAUTIONARY USAGE INSTRUCTIONS	8
CLEANING INSTRUCTIONS	9
PREVENTIVE MAINTENANCE	10

IMPORTANT NOTES ABOUT THIS MANUAL

This Field Installation and Usage Instruction document is designed to assist you with installation of the TransMotion Medical Product. Carefully read this document thoroughly before using the equipment or doing service/maintenance on it. If you are unable to understand the WARNINGS and CAUTIONS and instructions, contact TransMotion Medical customer service before attempting to operate or service the equipment otherwise injury or damage may result.

To assure safe operation of this device, it is essential that methods and procedures be established for educating and training staff on the safe and effective operation of the product.

TransMotion Medical reserves the right to change specifications without notice.

The information contained in this document is subject to change without notice.

Specifications listed are nominal and may vary slightly from unit to unit due to tolerance variations.

Photographs and illustrations contained within this document may not depict exactly the model you have. This document can cover many closely related models.

SPECIAL NOTES - SIGNAL WORDS

Signal words are used in this manual and apply to hazards which could result in injury or property damage. The following is a definition of those signal words as used in this document:



Indicates an imminently hazardous situation which, if not avoided, will result in death or serious injury.



Indicates a potentially hazardous situation which, if not avoided, could result in death or serious injury.



Indicates a potentially hazardous situation which, if not avoided, may result in minor or moderate injury. It may also be used to alert against unsafe practices or potential property damage hazards.



Provides important information, makes special instructions clearer, or provides service personnel information to make maintenance easier.

TOOLS REQUIRED

Tools required to install patient tray accessory:

- 9/16 Wrench



PARTS INCLUDED IN TMA71-15 KIT

Verify that you have all the parts shown. If not, contact TMM Service at 1-800-237-3377.

- (1) Phenolic Arm and Hand Table
- (2) Black pads



INSTALLING PHENOLIC ARM AND HAND TABLE

Position the chair in stretcher position.



Loosen the nut on the table by turning the wrench counter clockwise.

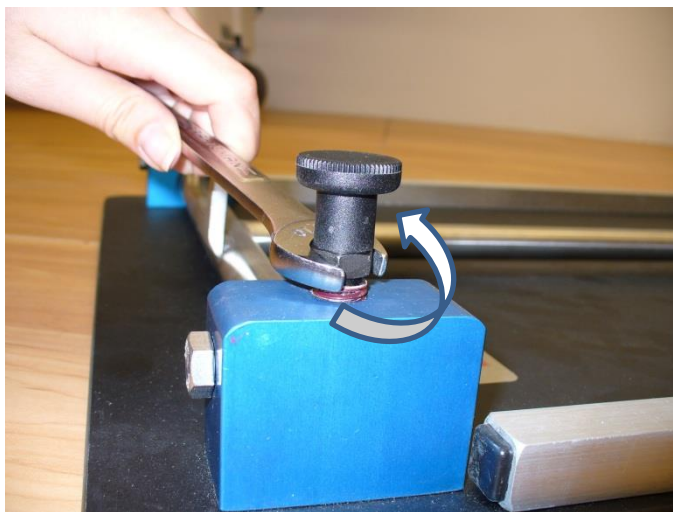

When the nut is loose, rotate the top black knob counter clockwise until the leg can move freely.



Swing the leg up until it is perpendicular and secure it by tightening the same nut and knob clockwise.



Loosen the knobs by twisting them counter clockwise.

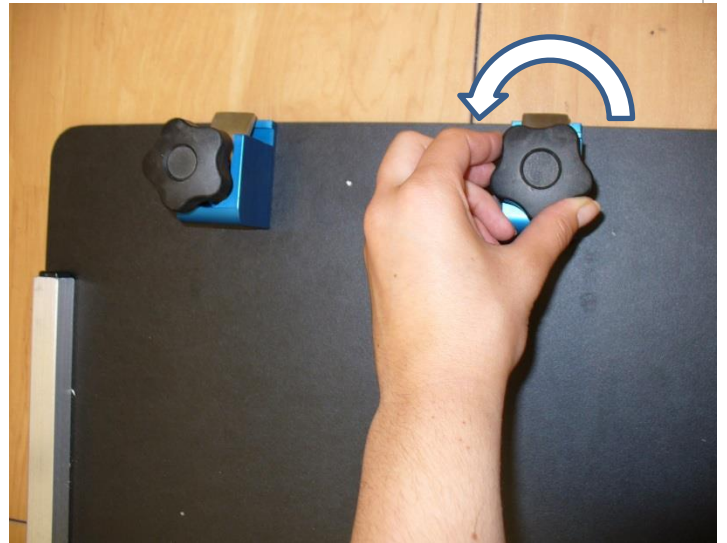

Turn the table upright, and fit it onto the accessory rail. Turn the knobs clockwise to secure the table to the accessory rail.



Adjust the leg height by loosening the knob counter clockwise, raising or lowering the leg, and then tightening the knob clockwise.

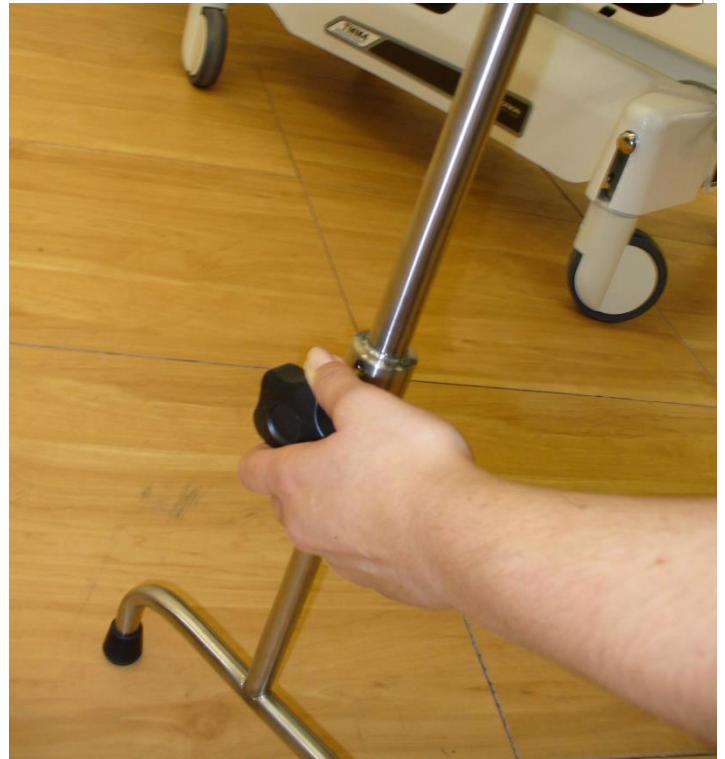

Separate the hook & loop strips on the black pad.



Take the hook and place the adhesive side on the table. Complete at the other end of the table.



Make sure the hook & loop on the table and pad are aligned.

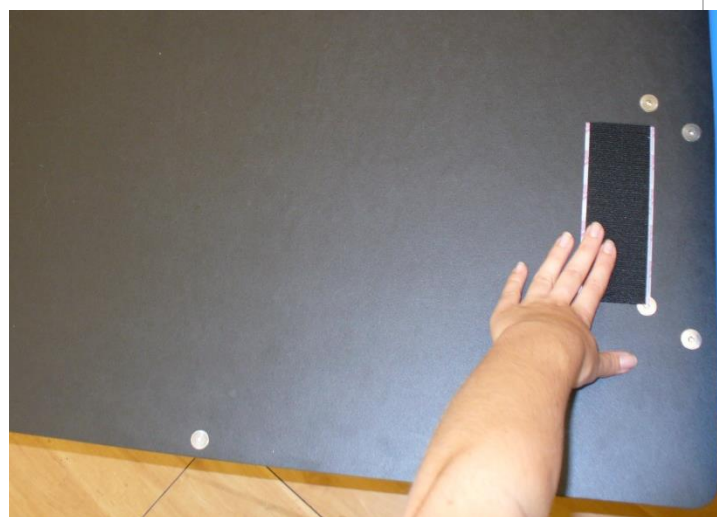

Place the pad on the table. The Phenolic arm and hand table is now ready for use.



CAUTIONARY USAGE INSTRUCTIONS

When using this accessory, please follow these cautionary usage instructions:

CAUTION CAUTION MUST BE USED WHEN THIS ACCESSORY IS UTILIZED WITH AN "X" SERIES CHAIR. DUE TO THE TILTING FEATURE OF THE "X" SERIES CHAIRS, OBJECTS MAY ROLL OR FALL OFF OF TABLE CAUSING SERIOUS INJURY TO PATIENT AND/OR MEDICAL STAFF.

CLEANING INSTRUCTIONS

⚠ CAUTION STEAM AND/OR PRESSURE CLEANING CHAIR WILL VOID WARRANTY

COMPONENT	FREQUENCY	PROCEDURE	CLEANING AGENT *	COMMENT
All Rails and Painted Metal	As required/in accordance with facility policies	Wipe with damp cloth and allow to air dry	Facility approved detergents, disinfectants & water	Check for chipped paint/chrome
Base Cover	As required/in accordance with facility policies	Wipe with damp cloth and allow to air dry	Facility approved detergents, disinfectants & water	Check for peeling or missing labels
Actuators and Battery Pack	As required/in accordance with facility policies	Wipe with damp cloth and allow to air dry	Facility approved detergents, disinfectants & water	Clean exterior surfaces only with minimal water
Pendants	As required/in accordance with facility policies	Wipe with damp cloth and allow to air dry	Facility approved detergents, disinfectants & water	Clean exterior surfaces only with minimal water
All Other Surfaces	As required/in accordance with facility policies	Wipe with damp cloth and allow to air dry	Facility approved detergents, disinfectants & water	Check for damage
TransMotion Medical Accessories	As required/in accordance with facility policies	Wipe with damp cloth and allow to air dry	Facility approved detergents, disinfectants & water	Check for damage
3rd Party Accessories	As required/in accordance with facility policies	Consult manual provided by accessory manufacturer.		

* Use of Facility approved detergents and disinfectants must comply with the instructions provided by the manufacturer(s) of those products.

Upholstery Care & Cleaning Instructions

Proper care is essential in ensuring the durability and reliability of TransMotion Medical upholstery. In general, all products should be:

1. Cleaned
2. Disinfected (in accordance with facility policy)
3. Rinsed
4. Allowed to air dry

It is important to note that the terms “disinfecting” and “cleaning” should not be used interchangeably. Disinfectants alone will not provide adequate cleaning since they do not have the appropriate properties to cut grease or oil and remove grime, hair or skin oils. The appearance, feel and performance of your upholstery may diminish if not cleaned properly.

Cleaning:

Remove hair, grime and body oils. Your upholstery should be cleaned on a regular basis with a damp cloth soaked in a mild soap and water solution. Avoid harsh detergents or chemicals that could damage the finish of your product. If disinfecting with manufacturer approved chemicals or bleach, the upholstery MUST be wiped off using clean water on a damp cloth and allowed to air-dry as a final step. Failure to rinse upholstery with clean water can result in a build-up of residues that, over time, may lead to drying, cracking or other undesirable changes to appearance, feel and performance.

Retain all instructional tags for future use.

Contact the manufacturer of the fabric used in your upholstery for a current list of approved disinfectants. TransMotion Medical Customer Care can assist with identifying which upholstery was used with your Stretcher-Chair.

For customer supplied and non-standard materials, please refer to the individual manufacturer’s cleaning instructions.

PREVENTIVE MAINTENANCE

To ensure proper operation, this accessory should be inspected and maintained as described below.

COMPONENT	FREQUENCY	PROCEDURE	TOOL	COMMENT
Locking Mechanism	Every three months	Inspect locking mechanism for proper locking capability.	-	Replace Phenolic Arm and Hand Table as needed.