

**PLEASE READ AND FAMILIARIZE YOURSELF WITH ALL INSTRUCTIONS BEFORE USING THIS PRODUCT.**

If you have trouble understanding these instructions, contact your dealer or Winco customer support at (800) 237-3377 before attempting to use this product; otherwise injury may occur.

**Winco assumes no responsibility for damage or injury caused by the improper assembly, installation or use of these products.**



### **WARNING**

**TO REDUCE THE RISK OF SEVERE INJURY OR DEATH TO PERSONS:**

1. READ AND FOLLOW ALL DIRECTIONS.
2. NEVER place screen on a cart, table, stand or other objects; Screen could fall and SERIOUS INJURY MAY OCCUR.
3. NEVER place screen near open flame or over a radiator or heat register.
4. NEVER place screen in front of a door; In case of emergency screen could block or hinder evacuation.
5. SUFFOCATION DANGER to children if vinyl is not attached to screen; Screen could block nose and mouth and prevent breathing. VINYL SCREEN IS NOT A TOY.
6. DO NOT allow children to play with screen; Screen could fall and SERIOUS INJURY MAY OCCUR.
7. Periodically, recheck tightness of all nuts, bolts and screws.
8. Screen should ALWAYS be positioned on level surface.
9. NEVER stand or ride on screen legs; SERIOUS INJURY MAY OCCUR.
10. DO NOT use screen in or with ANY type of vehicle or trailer.
11. DO NOT attach objects to screen frame; Screen can tip over and SERIOUS INJURY MAY OCCUR.
12. Immediately remove from service; Any screen with broken or missing parts, torn vinyl, or other visible damage.
13. USE ONLY WINCO AUTHORIZED REPLACEMENT PARTS.
14. SAVE THESE INSTRUCTIONS for future reference and training.

#### Tools needed:

- Phillips-Head Screwdriver
- 7/16" wrench, adjustable wrench, or 7/16" socket & ratchet wrench
- Scissors or box cutter
- If using powered tools always start hardware together by hand first

**PLEASE READ AND FAMILIARIZE YOURSELF WITH ALL INSTRUCTIONS BEFORE PROCEEDING WITH ASSEMBLY**

1. Insert caster inserts into ends of screen legs. (This is done for crutch tip or caster installation)
2. You must choose either casters or crutch tips for your screen – both are provided to you. Casters must be inserted into the caster inserts. Crutch tips (only available with 3130 model) must be installed over the ends of the legs.

#### **LEG INSTALLATION**

3. Install legs on mainframe using (4) ¼" x 1-1/2" Phillips head screws and locknuts.  
**NOTE:** Make sure the legs are installed so that the bends of the legs face the outside of the frame. This is necessary to provide the maximum footprint.
4. Use your Phillips head screwdriver and 7/16" wrench to tighten. Bolts must fit snugly into holes for secure leg mount.
5. Verify that your screen is level and straight. If necessary, the legs can be slightly bent so that all legs touch the floor and screen stands straight.

**PANEL REPLACEMENT**

6. To replace Vinyl Panels, grasp Screen Rod; Screen Rod is spring-loaded and can be moved toward end with spring. Push & pull the Screen Rod to determine which way will compress the spring and allow removal of the Screen Rod.
7. Re-install the Screen Rod by reversing the above procedure.
8. Periodically check all fasteners for tightness. To clean Vinyl Panels use only mild liquid soap and water.

**Wrinkles in Vinyl** – Storage and shipping causes wrinkles of the vinyl of your Winco Screen; This is normal. Please allow 1-2 weeks at room temperature (approx. 70+ degrees) to allow for vinyl to return to original appearance.



**WARNING**  
**TO PREVENT RISK OF INJURY**  
**NEVER stand or ride on screen legs.**  
**Do not over tighten nuts and bolts. Periodically recheck all fasteners for tightness.**

**3130 Model**

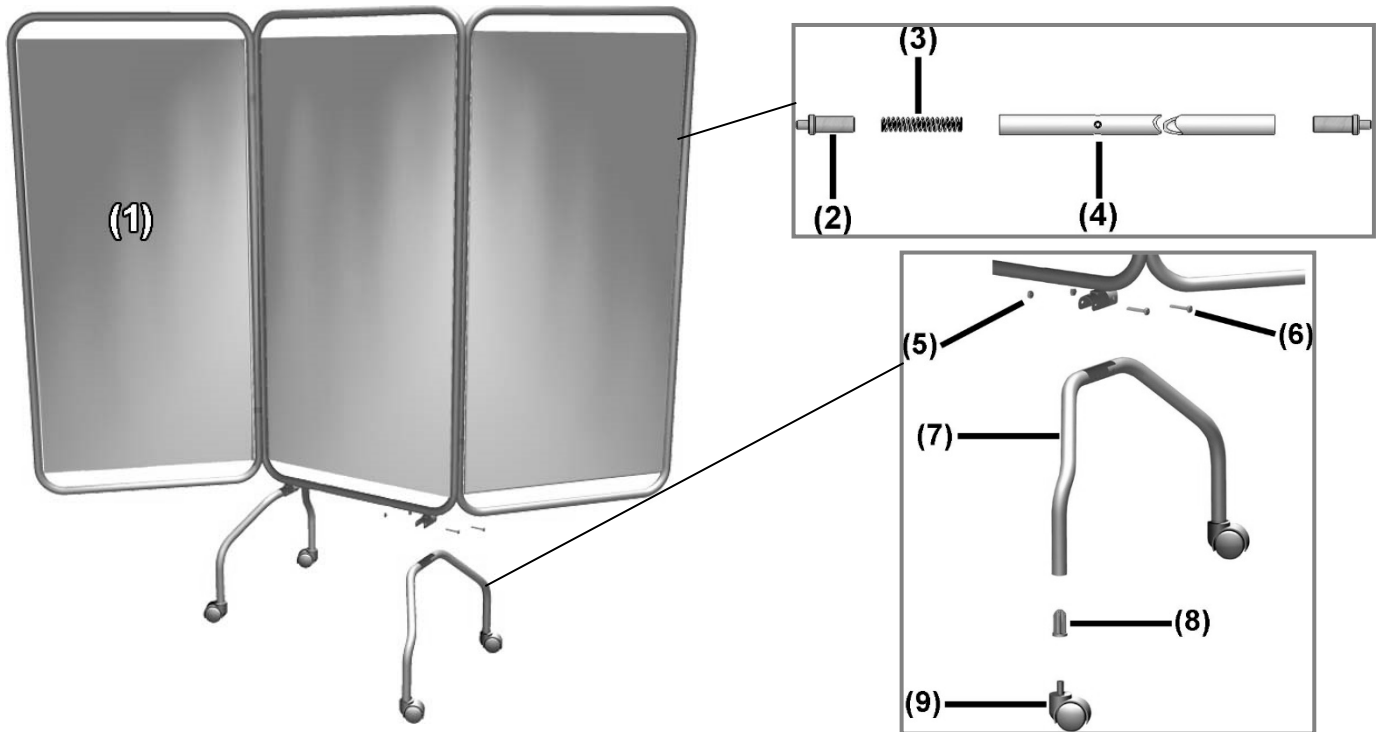

<u>Items Included with Screen:</u>	<u>Qty.</u>
(1) Vinyl Panel	3
(2) Insert, Screen Rod Plastic	12
(3) Rod Spring	6
(4) Screen Rod	6
(5) 1/4-20 Lock Nut	4
(6) 1/4-20 x 1-1/2" Machine Screw	4
(7) Double Leg	2
(8) Caster Insert	4
(9) Caster, 2"	4
NOT SHOWN: Crutch Tip, 1" gray w/ washer (Available with 3130 Model Only)	4

**3140 Model**

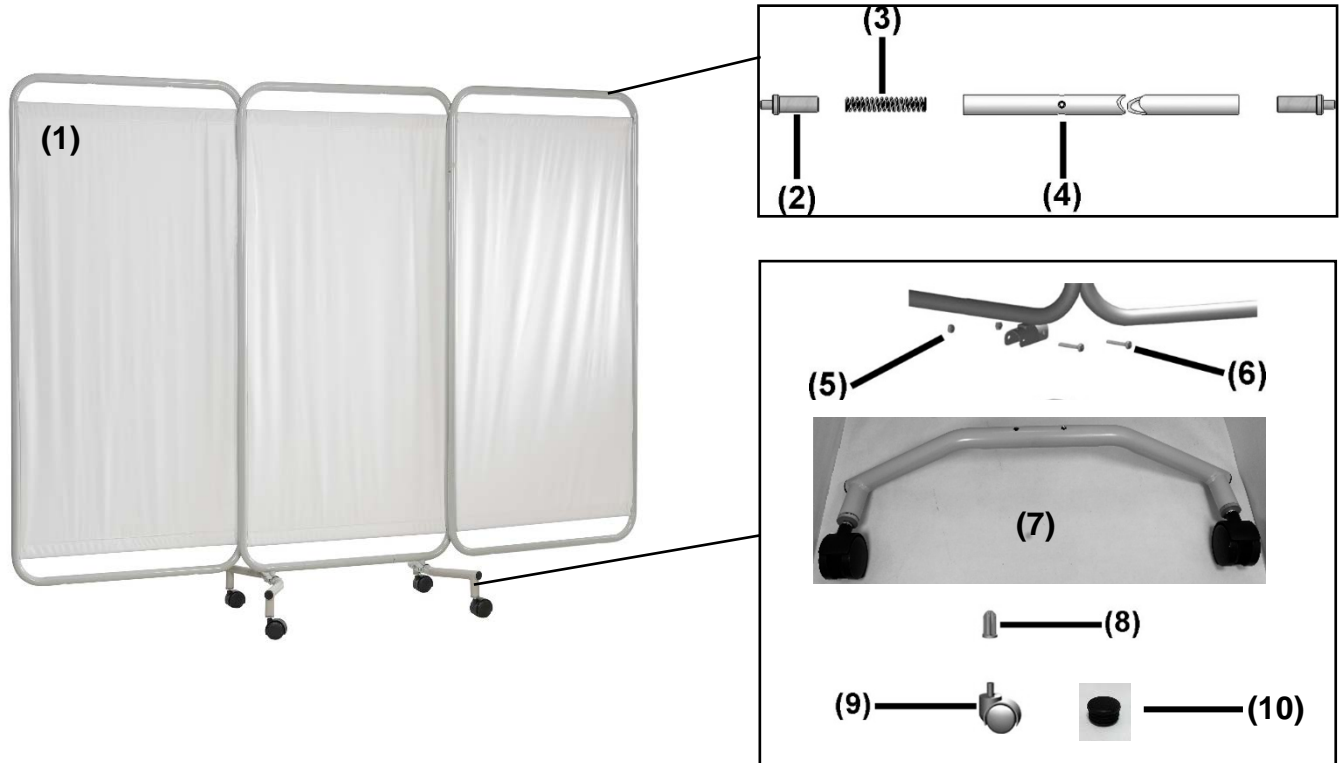

<u>Items Included with Screen:</u>	<u>Qty.</u>
(1) Vinyl Panel	3
(2) Insert, Screen Rod Plastic	12
(3) Rod Spring	6
(4) Screen Rod	6
(5) 1/4-20 Lock Nut	4
(6) 1/4-20 x 1-1/2" Machine Screw	4
(7) Welded Double Leg	2
(8) Caster Insert	4
(9) Caster, 2"	4
(10) 1" Round X 18 Gauge Black Cap	4

Visit our website [www.wincomfg.com](http://www.wincomfg.com) for additional parts lists or call Customer Service at 1-800-237-3377.

## **GENERAL CARE & CLEANING:**

Periodically inspect tightness of all screws, bolts, and nuts.

Winco furnishings are built to provide durable reliable service when properly cared for. In general, all our products should be 1) Cleaned 2) Rinsed 3) Allowed to air dry. It is important to note that disinfecting a product is not the same as cleaning the product. Disinfectants alone will not provide adequate cleaning, they do not have grease or oil cutting properties to remove grime or hair and skin oils. Over time, the appearance and feel and performance of your upholstery may diminish if not cleaned properly

## **CLEANING:**

Remove grime, hair and body oils; Your furnishings should be cleaned with mild soap & water solution and a damp cloth on a regular basis. Avoid harsh detergents that could damage the finish of your product. If the furnishing is disinfected with bleach, it **MUST** be wiped off using only clean water on a damp cloth and then be allowed to air dry. Failure to rinse with clean water can result in a build-up of residues over time that can damage your product.



## **CONTACT US**

To arrange a demonstration or to speak with one of our associates, please feel free to contact us at:  
**800-237-3377 | WincoMfg.com | 5516 SW 1st Lane, Ocala, FL 34474 | Info@WincoMfg.com**